

L57xxx2-V02
Termination Load 50 ohm
N / 4.3-10 / 7/16
DC-4000



Termination Load 50ohm DC-4000 2-25W

Type	N Female	L5730022-v02	L5730052-v02	L5730102-v02	L5730252-v02
	N Male	L5740022-v02	L5740052-v02	L5740102-v02	L5740252-v02
	4.3-10 Female	L5710022-v02	L5710052-v02	L5710102-v02	L5710252-v02
	4.3-10 Male	L5720022-v02	L5720052-v02	L5720102-v02	L5720252-v02
	7/16 Female	L5750022-v02	L5750052-v02	L5750102-v02	L5750252-v02
	7.16 Male	L5760022-v02	L5760052-v02	L5760102-v02	L5760252-v02
	Power Rating (W)	2	5	10	25
Frequency (MHz)	DC - 4000				
PIM3 (dBc, @2x33dBm)	≤ -120				
Impedance (Ω)	50				
Return Loss (dB)	≥ 21				
Dimension (mm) (excluding connector and bracket)	N Female: Ø22 x 47		All Connector Type: Ø60 x 46.5		
	N Male: Ø22 x 54				
	4.3-10 Female: Ø22 x 57				
	4.3-10 Male: Ø22 x 50				
	7/16 Female: Ø22 x 46				
	7/16 Male: Ø22 x 51				
Weight (kgs) (including connector and bracket)	N Female: 0.20		N Female: 0.30		
	N Male: 0.20		N Male: 0.30		
	4.3-10 Female: 0.20		4.3-10 Female: 0.30		
	4.3-10 Male: 0.20		4.3-10 Male: 0.30		
	7/16 Female: 0.25		7/16 Female: 0.35		
	7/16 Male: 0.25		7/16 Male: 0.35		
Ingress Protection	IP68				
Operating Temperature (°C)	-40 to +65				
Operating RH (%)	≤ 95				

Packing Information

Packing Size (mm)	2W/5W: 70 x 30 x 30 10W/25W: 160 x 70 x 70
SKU (unit/inner carton)	2W/5W: 100 pieces per inner carton/box 10W/25W: 50 pieces per inner carton/box

(D)20944560/20984560/20915560/20955560
(D)21044560/21084560/21015560/21055560
(D)22044560/22084560/22015560/22055560
(D)23044560/23084560/23015560/23055560
(D)24044560/24084560/24015560/24055560
(D)25044560/25084560/25015560/25055560

L57xxx2-V02
Termination Load 50 ohm
N / 4.3-10 / 7/16
DC-4000

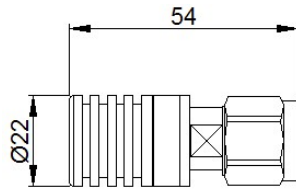

2W/5W N Female

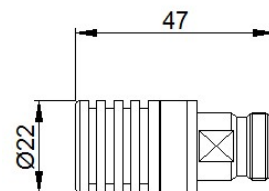

2W/5W N Male

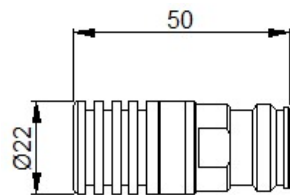

2W/5W 4.3-10 Female

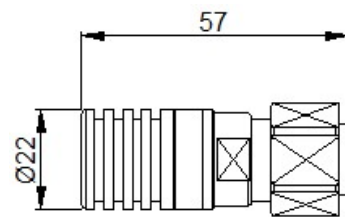

2W/5W 4.3-10 Male

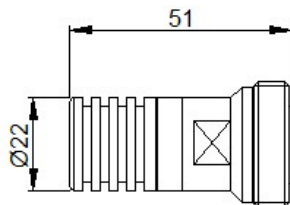

2W/5W 7/16 Female

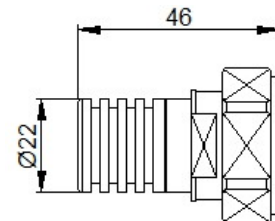

2W/5W 7/16 Male

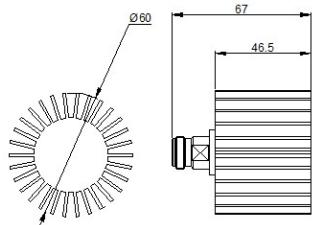

10W/25W N Female

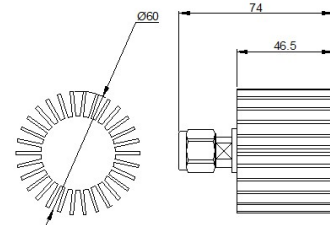

10W/25W N Male

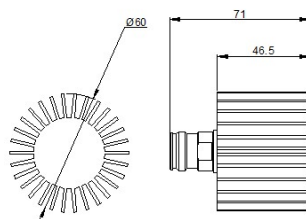

10W/25W 4.3-10 Female

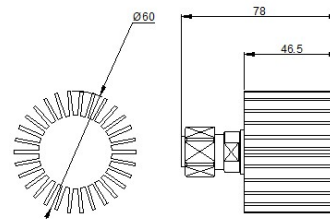

10W/25W 4.3-10 Male

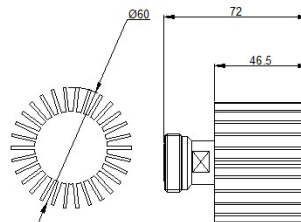

10W/25W 7/16 Female

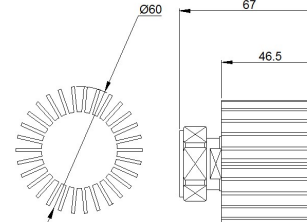

10W/25W 7/16 Male