

E56xxx25-V02
Attenuator 10W
N / 4.3-10 / 7/16
DC-4000



Attenuator DC-4000 10W

Type	N F/M	E5630325-V02	E5630625-V02	E5631025-V02	E5631525-V02
	4.3-10 F/M	E5610325-V02	E5610625-V02	E5611025-V02	E5611525-V02
	7/16 F/M	E5650325-V02	E5650625-V02	E5651025-V02	E5651525-V02
Attenuation (dB)		3	6	10	15
Attenuation Tolerance (dB)		±0.7	±0.7	±0.7	±0.7

Type	N F/M	E5632025-V02	E5633025-V02	E5634025-V02	
	4.3-10 F/M	E5612025-V02	E5613025-V02	E5614025-V02	
	7/16 F/M	E5652025-V02	E5653025-V02	E5654025-V02	
Attenuation (dB)		20	30	40	
Attenuation Tolerance (dB)		±0.7	±0.8	±0.8	

Electrical Specifications

Frequency (MHz)	DC - 4000
PIM3 (dBc, @2x33dBm)	≤ -120
Impedance (Ω)	50
Return Loss (dB)	≥ 21
Max Input Power (W)	10

Mechanical and Environmental Specifications

Dimension (mm)	Ø55 x 69 (excluding connector and bracket)
Weight (kgs)	N F/M: 0.30 (including connector and bracket)
	4.3-10 F/M: 0.30 (including connector and bracket)
	7/16 F/M: 0.35 (including connector and bracket)
Ingress Protection	IP55
Operating Temperature (°C)	-55 to +125
Operating RH (%)	≤ 95

Packing Information

Packing Size (mm)	160 x 70 x 70
SKU (unit/inner carton)	50 pieces per inner carton/box

(D)25N41660/25N71660/25N12660/25N62660/25N13660/25N14660/25N15660
(D)26N41660/26N71660/26N12660/26N62660/26N13660/26N14660/26N15660
(D)27N41660/27N71660/27N12660/27N62660/27N13660/27N14660/27N15660

E56xxx25-V02
Attenuator 10W
N / 4.3-10 / 7/16
DC-4000

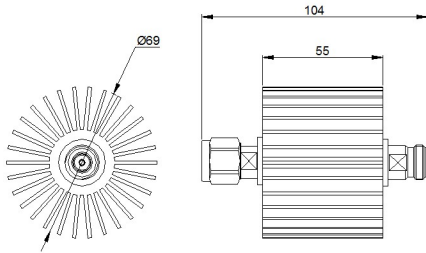

N F/M

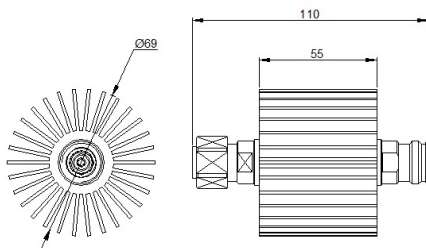

4.3-10 F/M

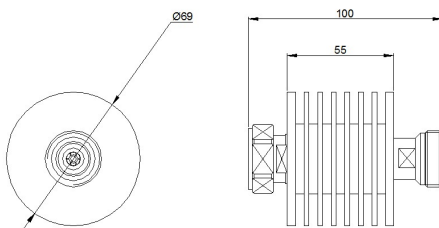

7/16 F/M