

E56xxx45-V02
Attenuator 50W
N / 4.3-10 / 7/16
DC-4000



Attenuator DC-4000 50W

Type	N F/M	E5630345-v02	E5630645-v02	E5631045-v02	E5631545-v02
	4.3-10 F/M	E5610345-v02	E5610645-v02	E5611045-v02	E5611545-v02
	7/16 F/M	E5650345-v02	E5650645-v02	E5651045-v02	E5651545-v02
Attenuation (dB)		3	6	10	15
Attenuation Tolerance (dB)		±0.7	±0.7	±0.7	±0.7

Type	N F/M	E5632045-v02	E5633045-v02	E5634045-v02	
	4.3-10 F/M	E5612045-v02	E5613045-v02	E5614045-v02	
	7/16 F/M	E5652045-v02	E5653045-v02	E5654045-v02	
Attenuation (dB)		20	30	40	
Attenuation Tolerance (dB)		±0.7	±0.8	±0.8	

Electrical Specifications

Frequency (MHz)	DC - 4000
PIM3 (dBc, @2x33dBm)	≤ -120
Impedance (Ω)	50
Return Loss (dB)	≥ 21
Max Input Power (W)	50

Mechanical and Environmental Specifications

Dimension (mm)	Ø60 x 85 (excluding connector and bracket)
Weight (kgs)	N F/M: 0.45 (including connector and bracket)
	4.3-10 F/M: 0.45 (including connector and bracket)
	7/16 F/M: 0.50 (including connector and bracket)
Ingress Protection	IP55
Operating Temperature (°C)	-55 to +125
Operating RH (%)	≤ 95

Packing Information

Packing Size (mm)	160 x 70 x 70
SKU (unit/inner carton)	50 pieces per inner carton/box

(D)28141660/28171660/28112660/28162660/28113660/28114660/28115660
(D)29141660/29171660/29112660/29162660/29113660/29114660/29115660
(D)20141660/20171660/20112660/20162660/20113660/20114660/20115660

E56xxx45-V02
Attenuator 50W
N / 4.3-10 / 7/16
DC-4000

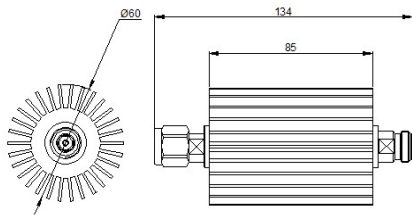

N F/M

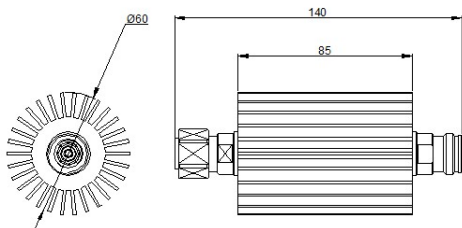

4.3-10 F/M

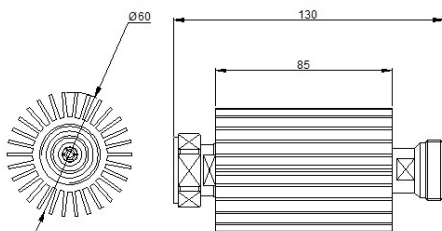

7/16 F/M