

E56xxx35-V02
Attenuator 25W
N / 4.3-10 / 7/16
DC-4000



Attenuator DC-4000 25W

Type	N F/M	E5630335-V02	E5630635-V02	E5631035-V02	E5631535-V02
	4.3-10 F/M	E5610335-V02	E5610635-V02	E5611035-V02	E5611535-V02
	7/16 F/M	E5650335-V02	E5650635-V02	E5651035-V02	E5651535-V02
Attenuation (dB)		3	6	10	15
Attenuation Tolerance (dB)		±0.7	±0.7	±0.7	±0.7

Type	N F/M	E5632035-V02	E5633035-V02	E5634035-V02	
	4.3-10 F/M	E5612035-V02	E5613035-V02	E5614035-V02	
	7/16 F/M	E5652035-V02	E5653035-V02	E5654035-V02	
Attenuation (dB)		20	30	40	
Attenuation Tolerance (dB)		±0.7	±0.8	±0.8	

Electrical Specifications

Frequency (MHz)	DC - 4000
PIM3 (dBc, @2x33dBm)	≤ -120
Impedance (Ω)	50
Return Loss (dB)	≥ 21
Max Input Power (W)	25

Mechanical and Environmental Specifications

Dimension (mm)	Ø60 x 55 (excluding connector and bracket)
Weight (kgs)	N F/M: 0.30 (including connector and bracket)
	4.3-10 F/M: 0.30 (including connector and bracket)
	7/16 F/M: 0.35 (including connector and bracket)
Ingress Protection	IP55
Operating Temperature (°C)	-55 to +125
Operating RH (%)	≤ 95

Packing Information

Packing Size (mm)	160 x 70 x 70
SKU (unit/inner carton)	50 pieces per inner carton/box

(D)22N41660/22N71660/22N12660/22N62660/22N13660/22N14660/22N15660
(D)23N41660/23N71660/23N12660/23N62660/23N13660/23N14660/23N15660
(D)24N41660/24N71660/24N12660/24N62660/24N13660/24N14660/24N15660

E56xxx35-V02
Attenuator 25W
N / 4.3-10 / 7/16
DC-4000

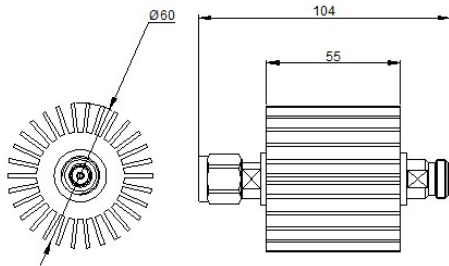

N F/M

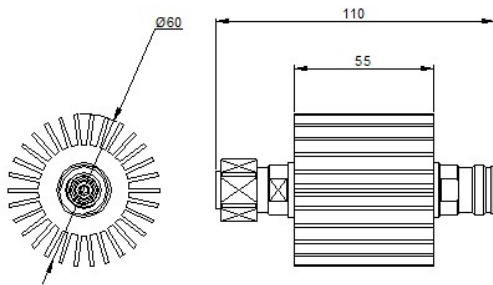

4.3-10 F/M

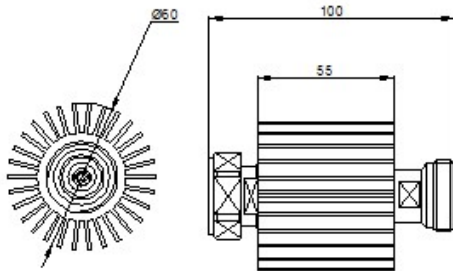

7/16 F/M